

CLOSED POSITION

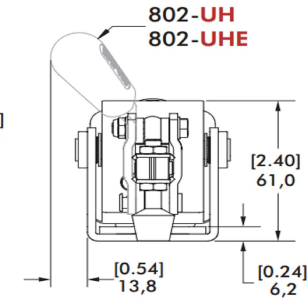

802-U / UH 1/8" NPT  
802-UE / UHE G-1/8

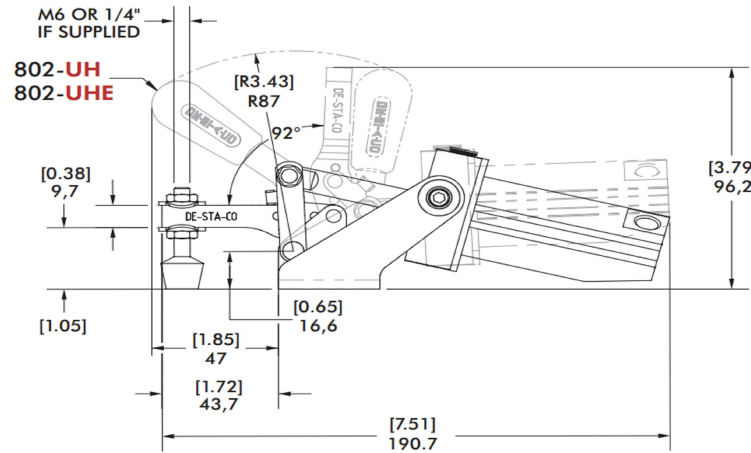
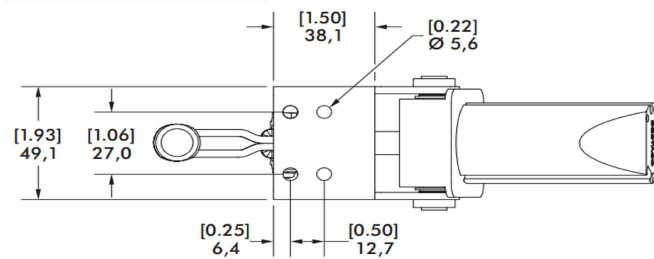
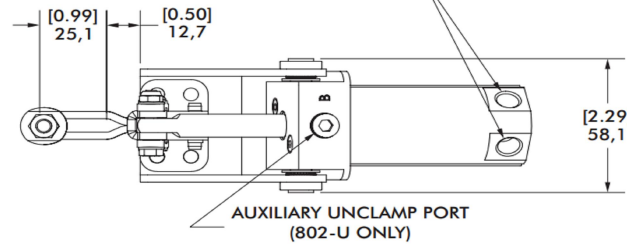

**NOTES :**

1. MAX. HOLDING CAPACITY INNER : 890 N [200 lbf]
2. MAX. HOLDING CAPACITY OUTER : 490 N [110 lbf]
3. WEIGHT : 0,73 kg [1.60 lb]
4. MAX. EXERTING FORCE @5 BAR [72 PSI] INNER : 2010 N [450 lbf]
5. MAX. EXERTING FORCE @5 BAR [72 PSI] OUTER : 1045 N [234 lbf]
6. REFER CATALOG PAGE FOR MORE DETAILS
7. DIMENSIONS AND TOLERANCES SUBJECT TO CHANGE WITHOUT PRIOR NOTICE

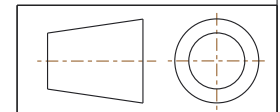

15 Corporate Drive,  
Auburn Hills, MI 48326, USA  
Phone: 888-337-8226, Fax: 800-682-9689  
www.destaco.com

This Drawing is the Property of DESTACO.  
It contains confidential, proprietary  
information that is DESTACO property. Do  
not disclose to or duplicate for others  
except as authorized by DESTACO.

COMPONENT		Pneumatic Toggle Clamps	
DIMENSIONS : [IN] MM	802-U	REV	04/08/19
		SHEET	1 of 1
TOLERANCES : ±[0.020] 0.51	802-SERIES		