

Arm Configuration

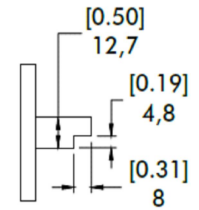

NOTES :

1. INLET PRESSURE : [70 ~ 150 PSI] 4,8 ~ 10,3 bar
2. EXERTING FORCE : [550 ~ 1200 lbf] 2450 ~ 5340 N
3. CLAMPING RANGE : [0.38] 9,6
4. WEIGHT : [4.00 lb] 1,81 kg
5. REFER CATALOG PAGE FOR MORE DETAILS
6. DIMENSIONS AND TOLERANCES SUBJECT TO CHANGE WITHOUT PRIOR NOTICE

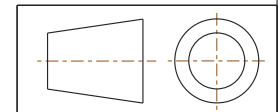

COMPONENT	Pneumatic Toggle Clamps	
DIMENSIONS : [IN] MM	1200-E	REV
TOLERANCES : ±[0.020] 0.51		09/04/19
	1200-SERIES	SHEET
		1 of 1



15 Corporate Drive,
Auburn Hills, MI 48326, USA
Phone: 888-337-8226, Fax: 800-682-9689
www.destaco.com

This Drawing is the Property of DESTACO.
It contains confidential, proprietary information that is DESTACO property. Do not disclose to or duplicate for others except as authorized by DESTACO.